



THE WESTWOOD PARKER



WESTWOOD PARK HOMES ASSOCIATION

KANSAS CITY, MO.

SPRING 2006

Redesign for park on track

A makeover for Westwood Park, first announced last year, is on the drawing board. Plans include re-routed walking trails, new shelters, benches and a garden.

Jimmi Lossing of the Kansas City Parks and Recreation Department unveiled the latest preliminary plan June 13 at a public meeting at the Westport Roanoke Community Center. (She also spoke at the April 6 Westwood Park Homes Association meeting.) Lossing said initial funding was available and construction could begin in spring 2007.

Lossing has been soliciting ideas from residents of Westwood Park and West Plaza. Her master plan (at left) represents the 9-acre park's first renovation in 20 years. The park was established in 1948.

At the April and June meetings, Lossing also said:

- Construction will be incremental. Initial funding of \$200,000 is earmarked for park improvements.

- An arborist will inventory trees and assess a maintenance program.

- Leashed dogs remain welcome in the park so long as owners pick up after them. West Plaza Neighborhood Association has maintained waste-bag dispensers installed by Parks and Rec. That duty could be shared by both associations.

- Anyone noticing undesirable activity in the park should call 911. If police fail to respond, call the Action Center, 513-1313.

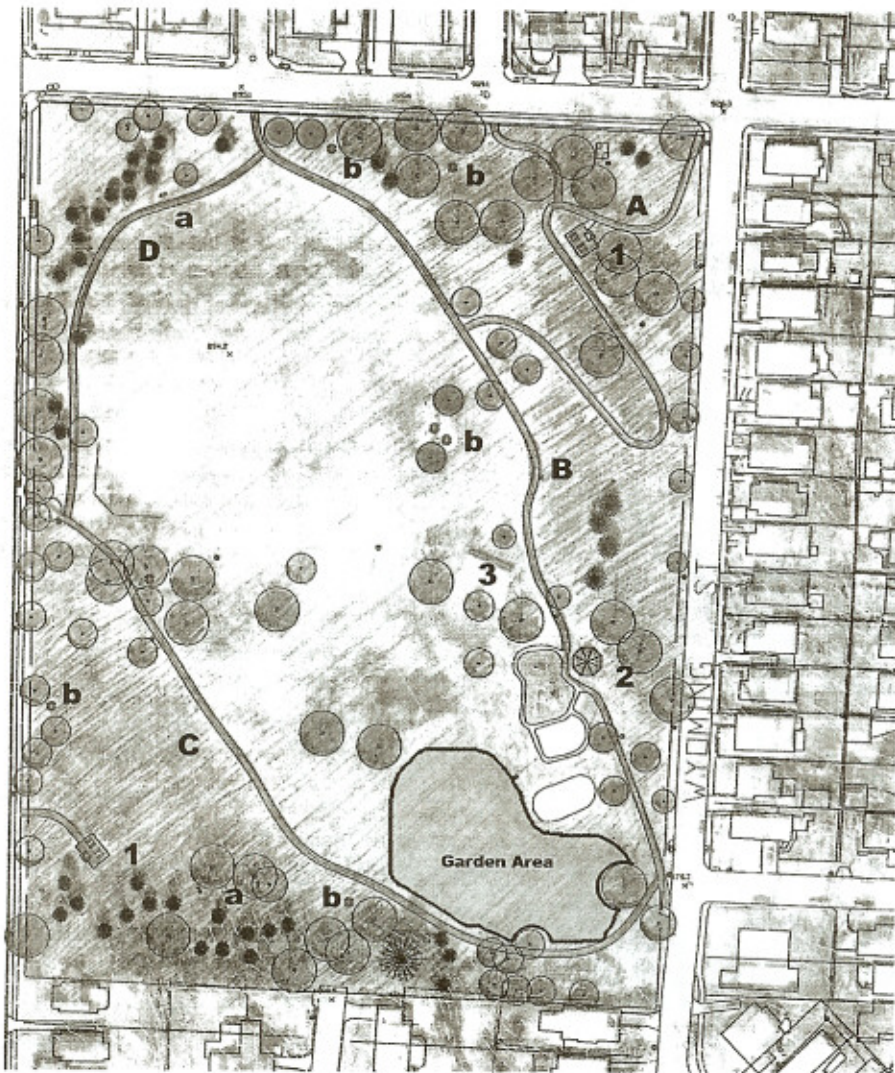

A new, improved Westwood Park

This rendering shows the preliminary plans for park improvements.

Walking trails: **A.** Northeast entrance trail replaces the existing one, providing handicap access to the interior of the park and to one of two new shelters. **B.** Eastern side of the interior loop trail provides access from the northern neighborhoods to the playground area. **C.** Southwest corner of the loop trail does not provide handicap access to the Garden Area. (Access to Bell Street, not shown, would be maintained.) **D.** Northwest corner of the loop trail replaces the existing path south of the baseball diamond.

Structures: **1.** Shelters are situated in the northeast and southwest corners of the park near street parking. The northeast shelter is accessible from walking trail A and the north sidewalk. The southwest shelter is accessible from the west sidewalk. **2.** A gazebo and drinking fountain are near the playground. **3.** The existing shelter and plaza area will be removed.

Site Furniture: Benches (a) and picnic tables (b) will be placed to take advantage of views into the park.

Garden Area: The southeast corner of the park becomes a garden. Possibilities include formal and native plantings as well as a pond or fountain.

Sleeker signs for tight spots

A few places in the Westwood Park neighborhood have no room for the stone pillars that have been built to mark entrance corners.

Those smaller sites will get modified markers, says board member Ann Nixon, who oversees neighborhood beautification and landscaping.

The scaled-back markers may look a lot like this conceptual sketch by architect and neighbor Kirk Gastinger. Cost estimates are pending.



Park plan tops annual meeting of WPHA board

The Westwood Park Homes Association board held its annual meeting April 6 in the cafeteria of the Pembroke Hill school.

Board member Chuck Stewart filled in for President Kirby Upjohn, who had broken her leg a day earlier.

Highlights of the meeting:

- Jimmi Lossing of the Kansas City Parks & Recreation Department, presented the master plan for Westwood Park improvements.

- Neighbor Teresa Larson reported the block representatives program, initiated last fall as a way to build a safer, friendlier neighborhood, is growing. Representatives are gathering neighbors' contact information, which will be compiled for a directory. Volunteers still are needed to be representatives for some blocks.

- Board member Ann Nixon reported most of the full-size stone entrance markers have been built. Smaller markers will be installed in corners with limited space. Recent annual dues have included voluntary payments of \$20 to help fund capital improvements, such as the markers. A motion was passed to extend voluntary payments through 2007.

- Board members Stewart, Glennis Walker and Dave Hardin were re-elected to three-year terms.

- A neighbor reported several break-ins near Liberty Street, and concluded the burglars were posing as a work crew waiting in a truck. Neighbors, especially those near construction projects, should be watchful. Call 911 if you see suspicious activities. And notify a board member.

Complete minutes and other WPHA information can be found online at www.haccd.org.

Magazines? Don't you believe it

Heard the one about the kid selling magazines to earn a scholarship?

If you live in Westwood Park you've probably heard it more than once. Someone rings your doorbell and announces that he or she is trying to win a scholarship, a session at summer camp or some other uplifting experience. To help this ambitious salesperson, you can buy a subscription to some familiar magazine, maybe one you already buy at the newsstand.

The pitch may be laced with talk about the young seller being "from the neighborhood" or being "just one or two sales away from winning the scholarship."

Don't believe any of it. There's no "scholarship" on the line, no "summer at camp," nothing but a business scam that uses young people to tug at the heartstrings of homeowners. Usually the young sales team is schooled in the pitch, driven to a pre-selected neighborhood, dropped off and told to canvass the community until another car picks them up a few hours later.

In most cases the magazine subscriptions are bogus. The magazines never arrive and the company that sold the subscription is long gone before you can track down your missing money.

Several of these teams have been working our neighborhood lately. So please, don't fall for the fake subscriptions or the phony appeals.

Also, door-to-door solicitations for charity are a little iffy. In most cases, less than half of your donation goes to the named charity. Your charitable dollars will go much farther if you donate directly to the charity of your choice and cut out the door-to-door middleman.

- Kirby Upjohn

New Neighbors

People who have purchased homes in the Westwood Park neighborhood since our last issue include:

Home of the Month

March

4971 Westwood Terrace
Alex & Deborah Buhayar



- Kristina Barns
5016 Wyoming
- Stevie Burks
4825 Fairmount
- Patricia Costello
1516 W. 51st. Street
- Peter Frick
4959 Westwood Terrace

Home of the Month

April

1410 W. 50th Street
Pamela Fike



- John Grant
4951 State Line
- Veronica Jaster
1417 W. 50th Terrace
- Theresa Juarez and
David Stewart
4912 Mercier
- Eric S. Krugh
1312 W. 50th Terrace
- Chris Leopold and
Sara Meinhard
4901 Mercier

Home of the Month

May

1401 W. 50th Terrace
Frank & Peggy Zilm



- Robert Pfeiffer
1615 W. 50th Street
- Mike and "Sam" Phillips
1200 Ward Parkway
- Thomas S. Pulley
4831 Liberty
- Gale Shultz
4809 Liberty
- Joseph Sullivan
4903 Bell



WPHA BOARD

PRESIDENT

Kirby Upjohn
1400 W. 50th
816-931-8959
kirbyup@aol.com

SECRETARY

Ann Schleih
4804 Bell
816-561-6340
aschle1@hallmark.com

TREASURER

Dave Hardin
4975 Westwood Terrace
816-668-9580
dave_hardin4975@yahoo.com

SPECIAL EVENTS

Chuck Stewart
2714 W. 48th Terrace
913-384-1600
hebdenbridge@aol.com

LANDSCAPING

Ann Nixon
1301 W. 50th
816-561-6125
anixon3030@aol.com

DIRECTORY

Glennis Walker
1403 W. 50th
816-960-3830
glenniswalker@yahoo.com

NEWSLETTER

Susan Hard
5000 Wyoming
816-531-1950
sehard@earthlink.net

Mark your calendar:

**NEIGHBORHOOD
BARBECUE**

Saturday
September 16

WESTWOOD PARK



KANSAS CITY
MISSOURI

Westwood Park
Homes Association
c/o Homes Associations
of the Country Club District
222 West Gregory
Suite 201
Kansas City, MO 64114
816-523-2440